

Terminal Type 端子类型

Plug-in Terminal 嵌入式端子

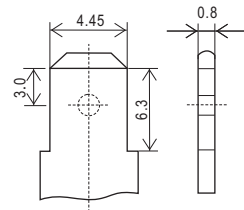

T0 (175)

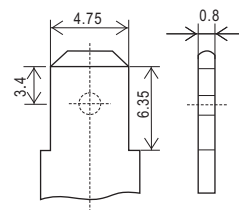

T1 (187)

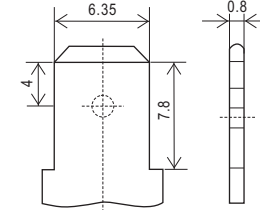

T2 (250)

Bolt nut Terminal 螺柱螺母式端子

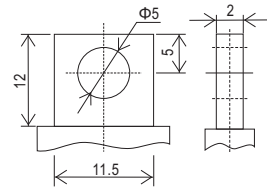

T3-A

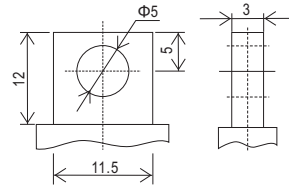

T3-B

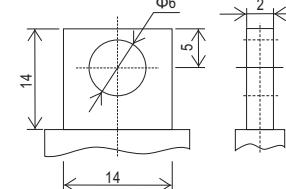

T4

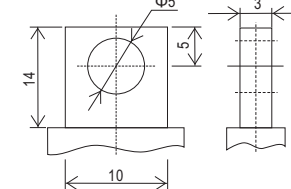

T5

Bolt nut Terminal (Lead) 螺柱螺母式端子(铅)

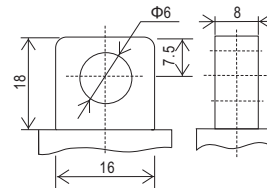

T6

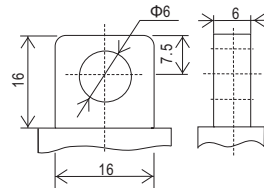

T7

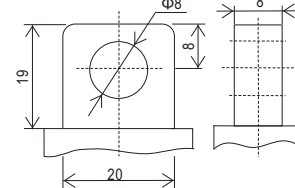

T8

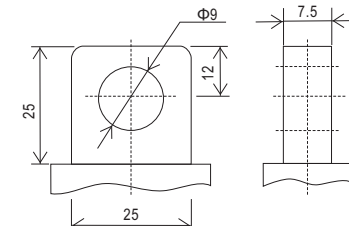

T9

Bolt nut Terminal (Height: 4mm) 螺母式端子(高度: 4mm)

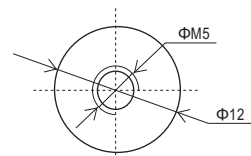

T10

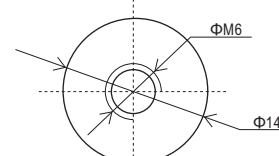

T11

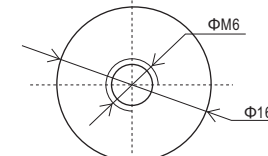

T12

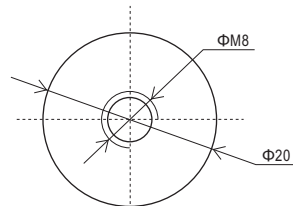

T13

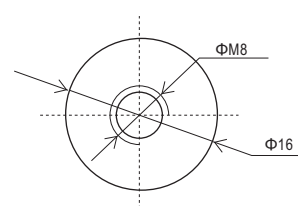

T14

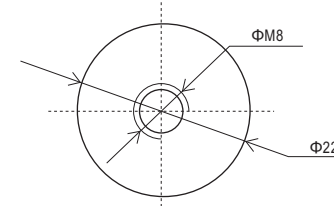

T15