

# EV6-155

6V155Ah / 10hr rate



### Introduction

**Generagy EV AGM Series** is designed for tough applications and repeated deep discharging. It is superior with the long cycle life, large current discharge capability, high reliability and safety. The range is the definitive choice for golf cart, electric medical equipment, automated guided vehicles (AGV), aerial lifts, floor cleaning equipment, robotics applications.

### Battery Features

- Extra long cycle life and resistance to mechanical stress and the elements all in one battery.
- Maintenance-free
- Very high purity lead (purity rate 99.994%)
- Traction heavy duty grid design gives consistent active material adhesion and corrosion resistance.
- Fully tank formed plates for evenly formed and capacity matched plates.
- Low impurity electrolyte
- Recognized gas recombination efficiency greater than 99.9%
- Flame arresting pressure regulated safety sealing valves for safety.
- Low self-discharge
- Classified as non-spillable and not restricted for transportation by
  - > Air (IATA/ICAO provision 67)
  - > Surface (DOT-CFR-HMR49)
  - > Water (per IMDG amendment 27)

### Electrical Specification

Design Life Cycles @ 80% D.O.D. (25°C) ..... 450 Cycles

Nominal Capacity @ 25°C /77°F

|     |           |                    |       |        |
|-----|-----------|--------------------|-------|--------|
| 100 | hour rate | 1.86 A to 1.75Vpc  | ..... | 186 Ah |
| 10  | hour rate | 15.5 A to 1.75Vpc  | ..... | 155 Ah |
| 5   | hour rate | 28 A to 1.75Vpc    | ..... | 140 Ah |
| 3   | hour rate | 41.33 A to 1.70Vpc | ..... | 124 Ah |
| 1   | hour rate | 93 A to 1.60Vpc    | ..... | 93 Ah  |

Minutes of Discharge

|              |       |     |             |       |     |
|--------------|-------|-----|-------------|-------|-----|
| 25A to 5.25V | ..... | 320 | 56A to 5.1V | ..... | 124 |
| 75A to 5.1V  | ..... | 86  | 85A to 5.1V | ..... | 70  |
| 100A to 5.1V | ..... | 54  |             |       |     |

Cranking Amps

0°C /32°F ..... 810      -18°C /0°F ..... 665

Internal Resistance

(Fully charged battery @ 25°C /77°F) ..... 4 mΩ

Max. Discharge Current @ 25°C /77°F ..... 930 A (5S)

Charge Methods: Constant voltage charge @ 25°C /77°F

|              |       |              |
|--------------|-------|--------------|
| Cycle Use    | ..... | 7.35 ~ 7.45V |
| Max. Current | ..... | 38.5 A       |
| Standby Use  | ..... | 6.8 - 6.9V   |

Operating Temperature Range ..... -20 ~ 60°C

Notes: battery voltage must be adjusted according to temperature.

Please refer to our recommendation.

Self-Discharge

3% of capacity declined per month @ 25°C (77°F).

### Battery Picture & Terminal Layout

ABS Case Colour  
7628C



Terminal Type: T14

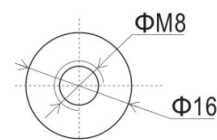

### Dimension & Weight

| Length    | Dimension (± 2mm) |          |          | Total Height | Weight (± 2%) |
|-----------|-------------------|----------|----------|--------------|---------------|
|           | Width             | Height   |          |              |               |
| 260 mm    | 180 mm            | 247 mm   | 250 mm   | 25.5 kg      |               |
| 10.2 inch | 7.1 inch          | 9.7 inch | 9.8 inch | 56.2 lbs     |               |

### Typical Applications

- Golf Cart
- Tour Bus
- Electric Medical Equipments
- Aerial and Fork Lifts
- Golf Trolley
- Sweeper
- Floor Cleaning Machines
- Marine and RV

### Certificates



# EV6-155

6V155Ah / 10hr rate



**Graphs**

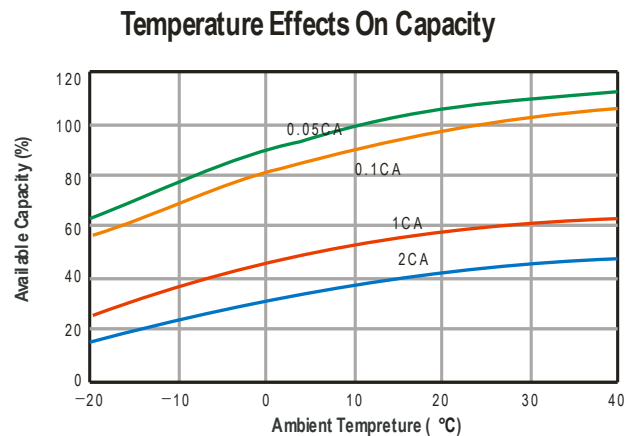
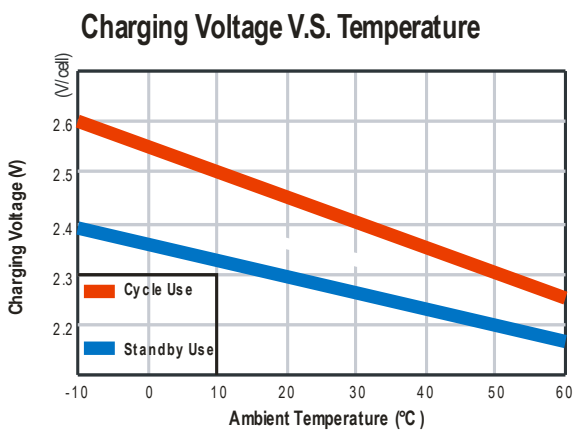
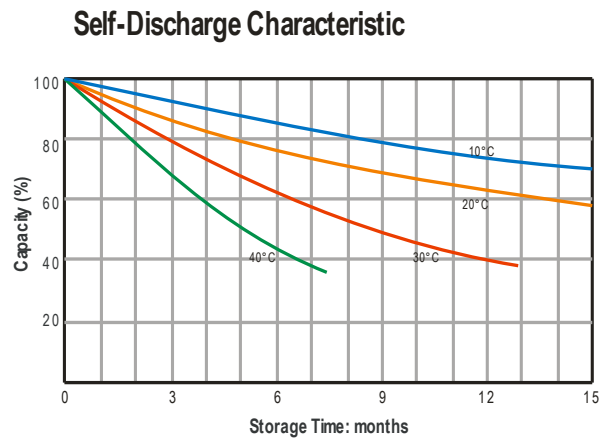
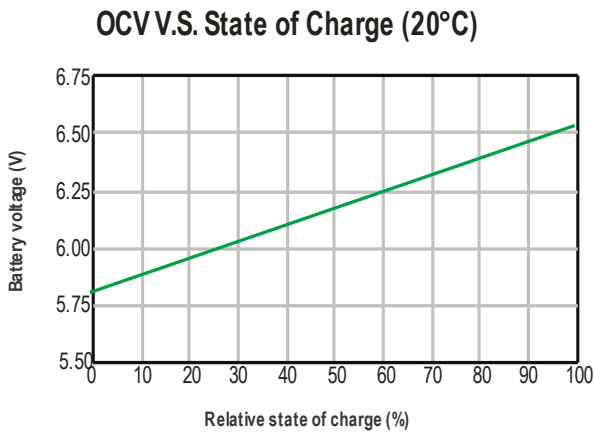
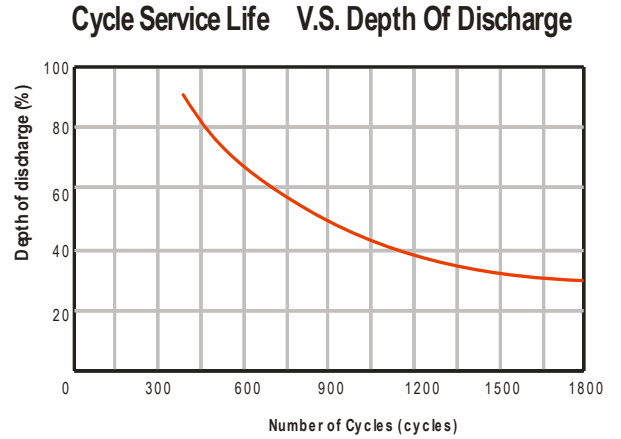
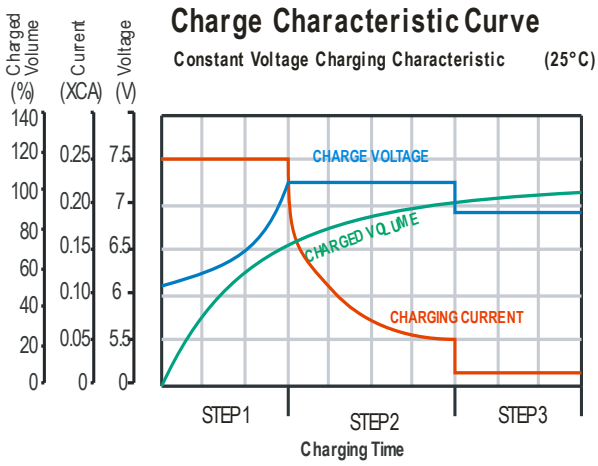

Subject to revision without notice. Please contact our sales representatives for latest version.